

AC EDGE Rack Mount PDU AC Breaker 120 Vac Single Pole 15A

3750-285 AC EDGE Breaker 15A 120V



Features

- Replacement Breaker for AC Edge Breaker (single) - 15 Amp
- Airpax SnapPac 15A, for 1101-1071

Applications

- Power Distribution
- Industrial Automation
- Telecommunications Base Stations
- First Responder Sites
- Emergency Management Systems
- Load Expansion

Electrical Specifications

Description	Minimum	Typical	Maximum	Units
Service Voltage		120		Vac
Frequency Range	50		60	Hz
Maximum Continuous Operating Voltage (MCOV)				
L - N			138	Vac
Current Rating			15	A

Mechanical Specifications

Size

Length	2.12 in	[53.85 mm]
Width	0.77 in	[19.56 mm]
Height	1.56 in	[39.62 mm]
Weight	0.06 lbs	[27.22 g]
Enclosure Material and Plating	Black Plastic	

Monitoring and Control

Alarm Relays	0
--------------	---

Environmental Specifications

Temperature Continuous	-40 to +85 deg C
------------------------	------------------

Click the following link (or enter part number in "SEARCH" on website) to obtain additional part information including price, inventory and certifications:
[AC EDGE Rack Mount PDU AC Breaker 120 Vac Single Pole 15A 3750-285](#)

AC EDGE Rack Mount PDU AC Breaker 120 Vac Single Pole 15A

3750-285 AC EDGE

Transtector Systems specializes in protection of highly sensitive, low voltage equipment through its patented, non-degrading silicon diode technology and custom filters. Our power quality expertise translates into a diverse product offering including AC, DC, and signal applications as well as integrated cabinets, power distribution panels and EMP hardened devices.

Click the following link (or enter part number in "SEARCH" on website) to obtain additional part information including price, inventory and certifications: [AC EDGE Rack Mount PDU AC Breaker 120 Vac Single Pole 15A 3750-285](#)

URL: <https://www.transtector.com/ac-edge-rack-mount-pdu-ac-breaker-3750-285-p.aspx>

The information contained in this document is accurate to the best of our knowledge and representative of the part described herein. It may be necessary to make modifications to the part and/or the documentation of the part, in order to implement improvements. Transtector reserves the right to make such changes as required. Unless otherwise stated, all specifications are nominal. Transtector does not make any representation or warranty regarding the suitability of the part described herein for any particular purpose, and Transtector does not assume any liability arising out of the use of any part or documentation.

AC EDGE Rack Mount PDU AC Breaker 120 Vac Single Pole 15A

3750-285 CAD Drawing

REVISIONS		
REV.	DESCRIPTION	DATE
A	INITIAL RELEASE	1/17/19
		APPROVED
		DWR

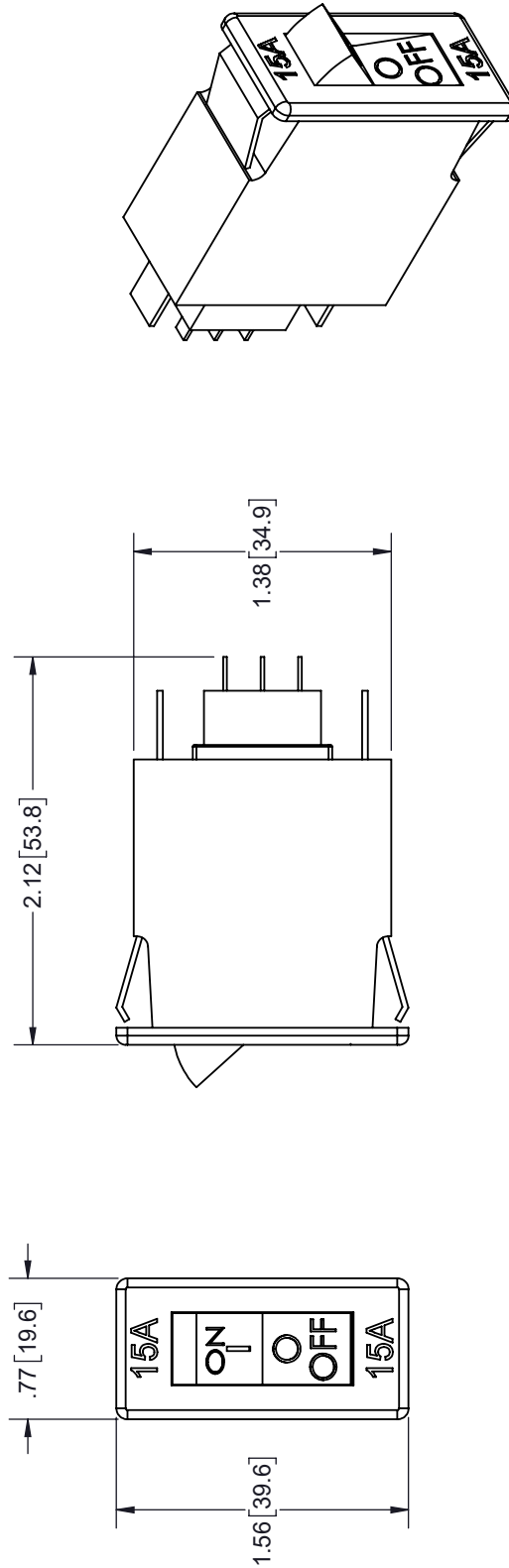

<p>UNLESS OTHERWISE SPECIFIED LEADING DIMENSIONS ARE INCHES DIMENSIONS IN [] ARE MILLIMETERS</p> <p>TOLERANCES:</p> <table border="0"> <tr> <td>.X=±.2 [5.08]</td> <td>FRACTIONS</td> <td>±.132</td> </tr> <tr> <td>.XX=±.01 [.25]</td> <td></td> <td>±.132</td> </tr> <tr> <td>.XXX=±.005 [.13]</td> <td>ANGLES ±1°</td> <td></td> </tr> </table> <p>ALL DIMENSIONS SHOWN ARE FOR REFERENCE ONLY.</p> <p>THIRD-ANGLE PROJECTION</p>	.X=±.2 [5.08]	FRACTIONS	±.132	.XX=±.01 [.25]		±.132	.XXX=±.005 [.13]	ANGLES ±1°		<p>THE INFORMATION AND DESIGN IN THIS DOCUMENT IS THE PROPERTY OF TRANSTECTOR CORPORATION. ALL RIGHTS RESERVED.</p> <p>SHEET 1 OF 1</p> <p>SCALE 1:1</p>
	.X=±.2 [5.08]	FRACTIONS	±.132							
.XX=±.01 [.25]		±.132								
.XXX=±.005 [.13]	ANGLES ±1°									
<p>TRANSTECTOR</p> <p>10701 AIRPORT ROAD, HAYDEN, ID, 83835 PHONE: 1.208.635.6400 1.800.882.9110 FAX: 1.208.955.2041 www.transvector.com e-mail: sales@transvector.com</p>	<p>REV A</p> <p>PART NUMBER 3750-285</p>									

THESE COMMODITIES, TECHNOLOGY OR SOFTWARE WERE EXPORTED FROM THE UNITED STATES IN ACCORDANCE WITH THE EXPORT ADMINISTRATION REGULATIONS. DIVERSION CONTRARY TO U.S. LAW PROHIBITED.

T-Rev.A